

23 Northumberland Avenue MOUNT COLAH NSW

2  **1**  **1** 

This modernist, architect designed residence bears striking resemblance to Harry Seidler's iconic style, offering a timeless sleek interior aesthetic beyond its sturdy double brick facade. Around 960sqm embraces tranquil natural bushland in an utterly private, elevated position with every amenity mere footsteps away.

Type : House
Land Size : 961 sqm
View : <https://www.mcdonaghrealestate.com.au/sale/nsw/north-shore-upper/mount-colah/residential/house/7473715>

Forever stylish timber finishes, bare brick and exposed beams complement huge floor to ceiling glass sliders and windows that showcase captivating outlooks and flood the home with natural light.

Expansive open plan living flows outside to the new mini deck, and rear garden. A sleek industrial theme pervades the spacious new kitchen, finished with polished concrete

[For full version visit the website](#)

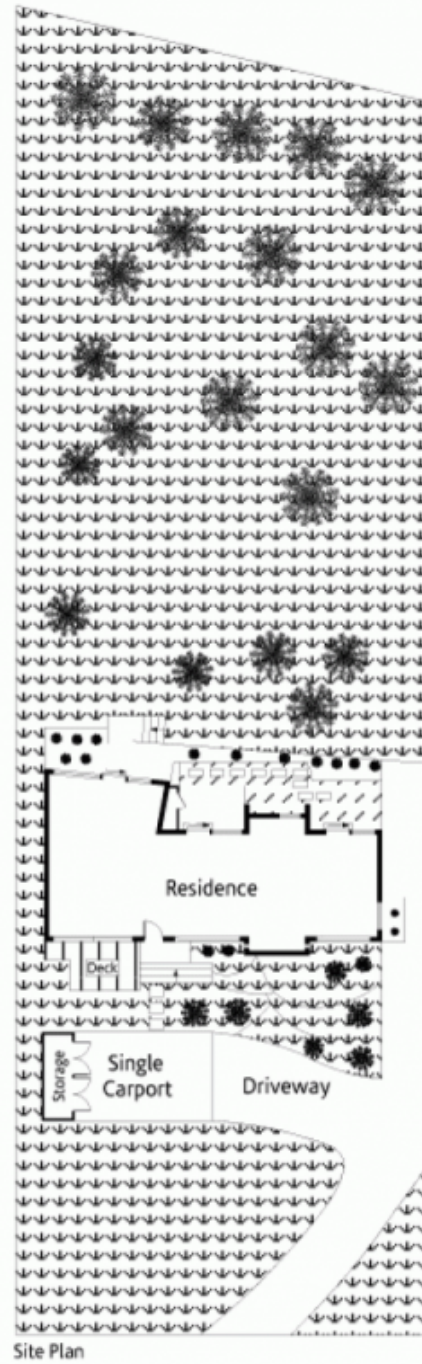
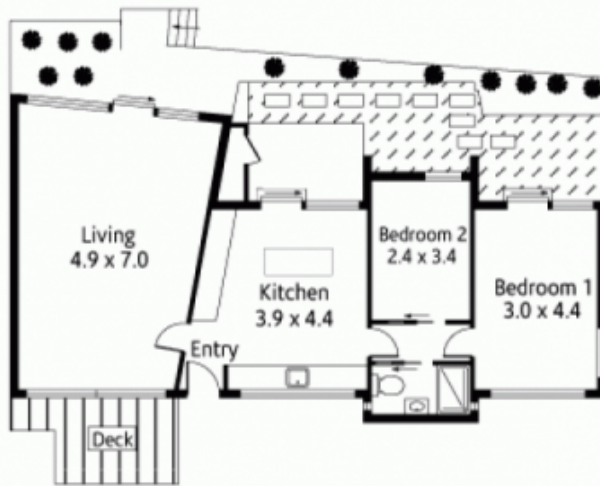

Every effort has been taken to ensure the information in this brochure is accurate to the best of our knowledge, however it is a guide only and no detail should be relied upon. McDonagh Blake accepts no liability for how the information is used.

Council | \$352.65pq

Water | \$172.55pq

Land | 961sqm

Contract | mcdonaghblake.com

mcdonagh blake