



**133 Woodcourt Road BEROWRA HEIGHTS NSW**

4 2 2

This lovingly maintained family home neighbours untouched bushland, and backs onto a spectacular terraced native landscape that basks the dwelling in tranquility on around 1839sqm.

The sun-filled interior marries earthy tones with timber joinery as a warm, inviting ambience that instantly feels like home. L-shaped living and dining is equipped with reverse cycle air conditioning, and flows through French doors to the all-weather entertainer's deck.

Two of the four bedrooms boast built-in wardrobes and polished timber floors. Utilise the study as a superb work from home environment, or as a fifth bedroom. The lower level embraces a large carport, storage area, second

**Type** : House  
**Land Size** : 1839 sqm  
**View** : <https://www.mcdonaghrealestate.com.au/sale/nsw/hawkesbury/berowra-heights/residential/house/7473712>

[For full version visit the website](https://www.mcdonaghrealestate.com.au)

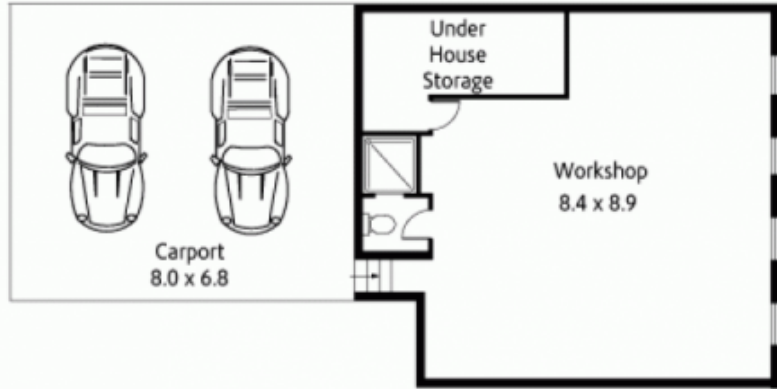
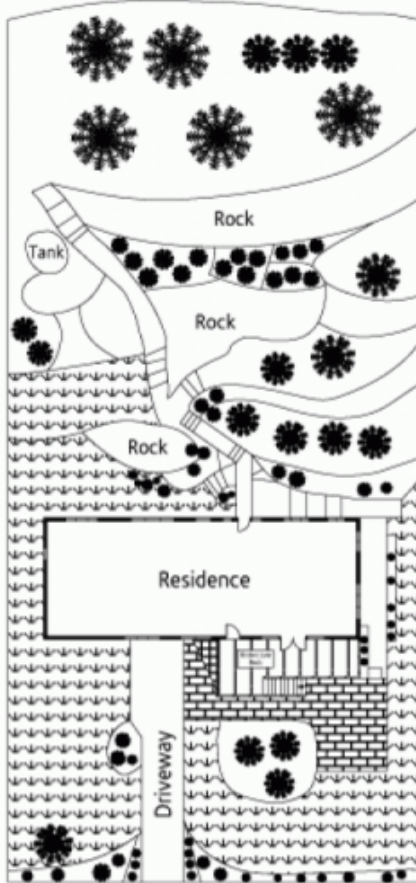

Every effort has been taken to ensure the information in this brochure is accurate to the best of our knowledge, however it is a guide only and no detail should be relied upon. McDonagh Blake accepts no liability for how the information is used.

Council | \$409.20pq

Water | \$173.00pq

Land | 1,839sqm

Contract | [mcdonaghblake.com](http://mcdonaghblake.com)

# mcdonagh blake