



2 Collingridge Way BEROWRA NSW

4 2 2

Luxuriously appointed family home exudes modern style over two expansive levels, privately poised within "Illoura Estate". The exclusive residential enclave offers a range of resort-like facilities as the ultimate lifestyle address in peaceful Berowra.

Type : House
Land Size : 443 sqm
View : <https://www.mcdonaghrealestate.com.au/sale/nsw/north-shore-upper/berowra/residential/house/7473706>

A superb north aspect to the rear offers plenty of natural illumination throughout. Contemporary finishes decorate the freshly painted interior, where neutral hues, plush carpet and high ceilings unfold over a flexible, family-friendly floor plan. Several large open plan living and dining areas spoil the family for choice, and multiple glass sliders cater to a seamless indoor outdoor lifestyle in utter privacy.

[For full version visit the website](#)

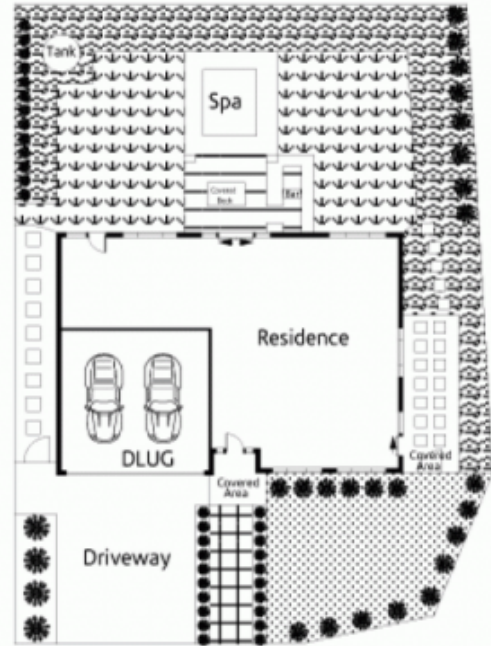
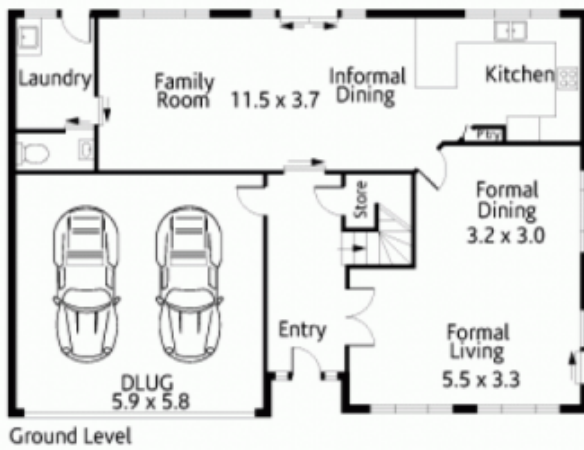

Every effort has been taken to ensure the information in this brochure is accurate to the best of our knowledge, however it is a guide only and no detail should be relied upon. McDonagh Blake accepts no liability for how the information is used.

Council | \$370.30pq Water | \$176.03pq Estate Fees | \$482.68pq Contract | mcdonaghblake.com

mcdonagh blake