



10 Grevillea Crescent HORNSBY HEIGHTS NSW

4  2  2 

Attractive cedar and brick residence comprising two welcoming levels of flexible family living captures sweeping elevated views across Walls Gully. Poised on a lush parcel of around 705sqm, the dwelling faces sunny east in a fabulous location - a brief stroll to every possible convenience.

Energising natural light floods the well presented interior through large windows and several skylights. The spacious, user-friendly layout embraces open plan living, a rumpus and a choice of dining areas. Multiple sliders seamlessly extend the interior to the all-weather deck as the ultimate setting in which to entertain against the stunning natural backdrop.

Type : House
Price : \$ 650,000
Land Size : 705 sqm
View : <https://www.mcdonaghrealestate.com.au/sale/nsw/north-shore-upper/hornsby-heights/residential/house/7473671>

[For full version visit the website](https://www.mcdonaghrealestate.com.au)

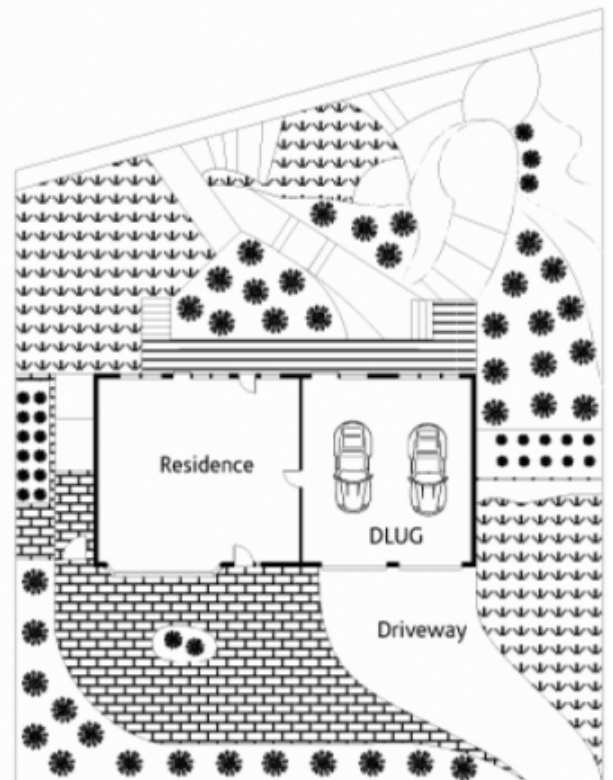
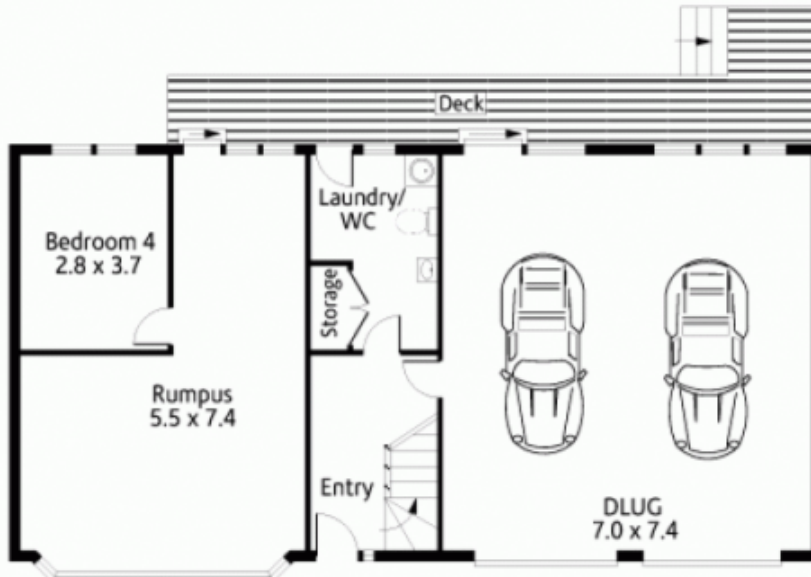

Site Plan