





5 Rosemead Road HORNSBY NSW

5  2  2 

Elegant 1890s "Edenholme" has been flawlessly preserved and extended as the ultimate family home, and a breathtaking tribute to Victorian era yesteryear. Manicured grounds of around 770sqm occupy prime position on the high side of the road in the tightly held Mt Errington heritage area.

Type : House
Land Size : 771 sqm
View : <https://www.mcdonaghrealestate.com.au/sale/nsw/north-shore-upper/hornsby/residential/house/7473639>

Sturdy brick structure with slate tiled roofing and original iron latticework set the timeless tone and allude to the graceful, old world interior. Generosity of space geared for effortless free flow between a choice of living, family and outdoor settings define the functional, user friendly layout.

The original construction serves as a stunning vintage showcase where 10 foot ceilings with majestic cornice and

[For full version visit the website](https://www.mcdonaghrealestate.com.au)

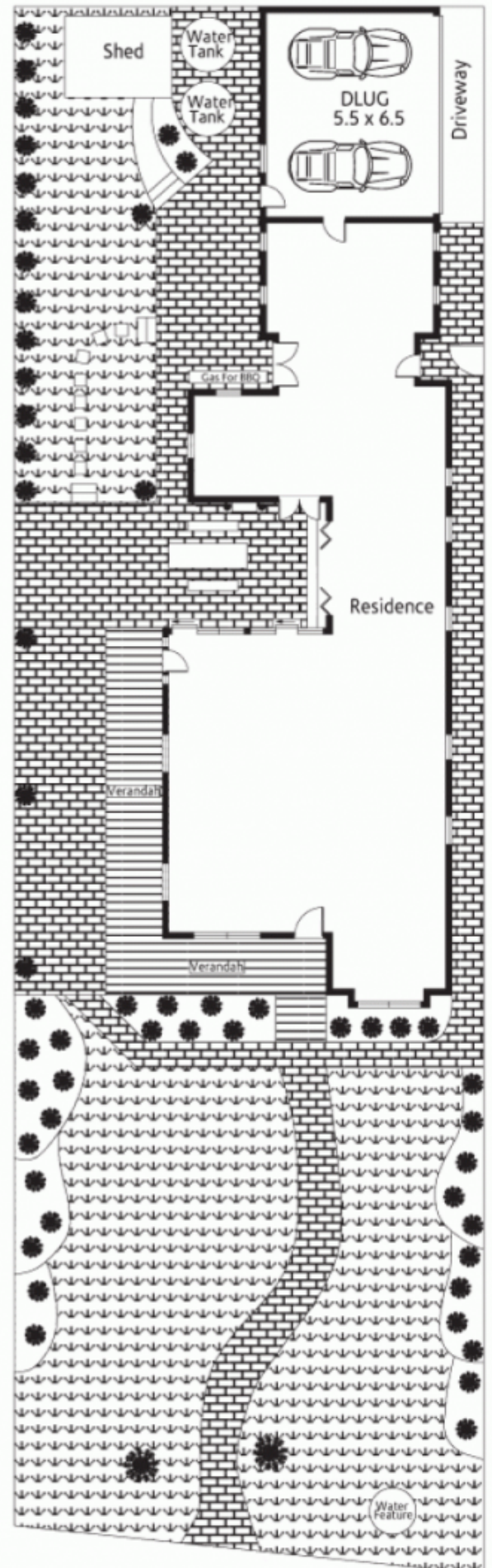
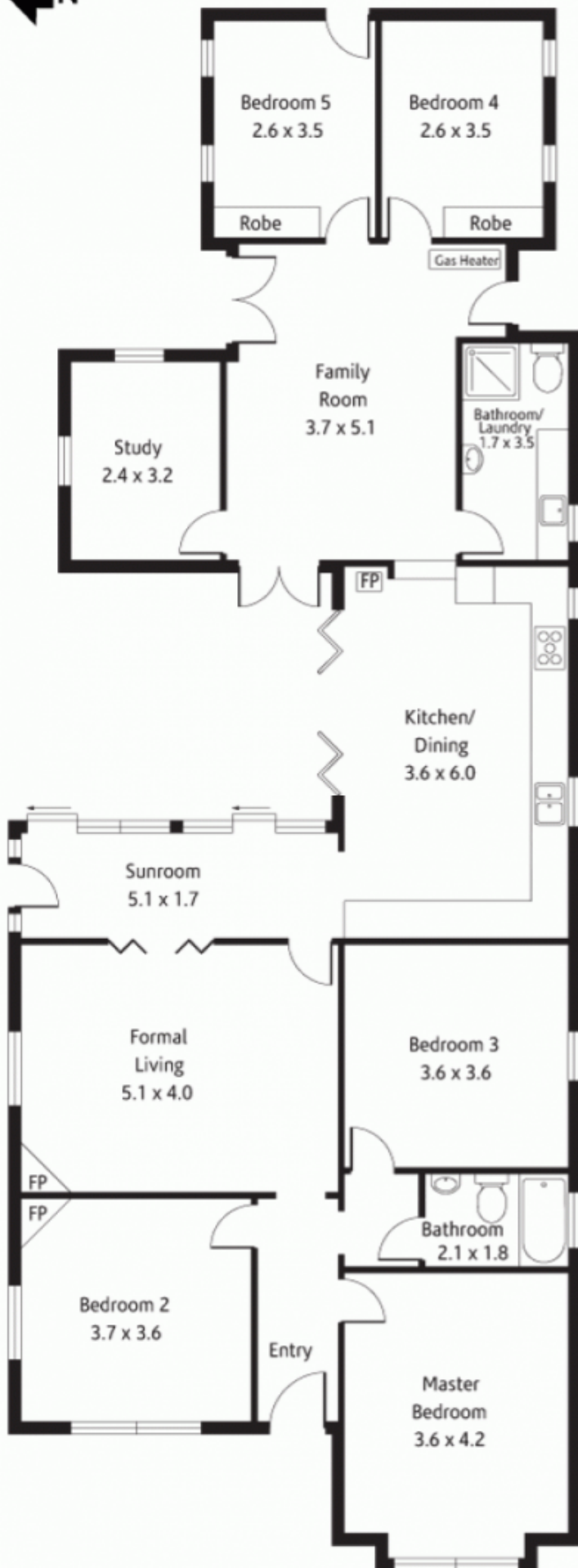

5 Rosemead Road Hornsby

Council Rates: \$411.00pq approx.
Water Rates: \$172.00pq approx.
Land Size: 771.8sqm approx.

McDonagh Blake has taken every effort to ensure the information in this brochure is accurate to the best of our knowledge, however, it is a promotional document only for use as a guide, and no detail should be relied upon. McDonagh Blake accepts no liability for how the information is used.