





10 Calga Avenue NORMANHURST NSW

5  2  1 

A beautiful extension and enhancement has transformed full brick centenary bungalow, "Tall Trees", into a stunning two storey family residence. The home stands as a charismatic statement in style and a tribute to its heritage amid a lush approx 900sqm parcel - formerly an apple orchard plantation.

Generosity of space across a family friendly layout appointed with luxurious modern fittings defines the flawlessly presented interior featuring high ceilings with exposed beams over ash hardwood floors. Large windows elegantly fitted with plantation shutters imbue the home with natural light, frame private tranquil green outlooks, and provide beautiful cross breezes.

Type : House
Land Size : 900 sqm
View : <https://www.mcdonaghrealestate.com.au/sale/nsw/north-shore-upper/normanhurst/residential/house/7473635>

[For full version visit the website](https://www.mcdonaghrealestate.com.au)

<https://www.mcdonaghrealestate.com.au>

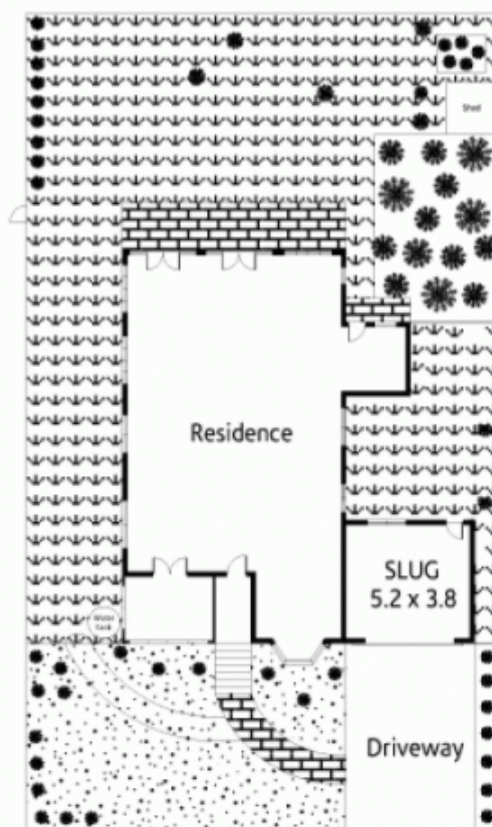

Site Plan