





15 Mittabah Road HORNSBY NSW

4  3  2 

No stone has been left unturned in the designer overhaul of this unique family property as the ultimate statement in home style and a one-off Hornsby find. Superb attention to decor detail across a striking split level interior effortlessly interacts with beautifully landscaped pool grounds. Lofty natives provide elevated views and a captivating natural backdrop to approx 727sqm.

Gardens geared for low maintenance exude an Australian rainforest flavour with established tree ferns and cycads alongside railway sleepers and bush rock features.

Inside, an open plan layout comprises soaring sloping ceilings and exposed timber beams, with a warm earthy colour palette, dark cedar features and abundant glass. Air

Type : House
Land Size : 727 sqm
View : <https://www.mcdonaghrealestate.com.au/sale/nsw/north-shore-upper/hornsby/residential/house/7473592>



Peter McDonagh
 0410 587 856

[For full version visit the website](https://www.mcdonaghrealestate.com.au)

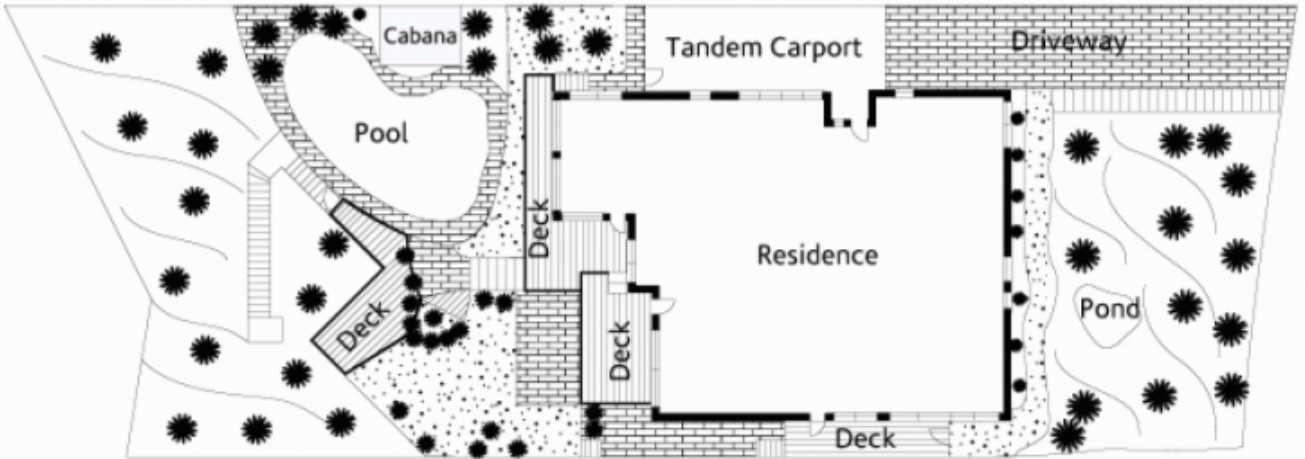
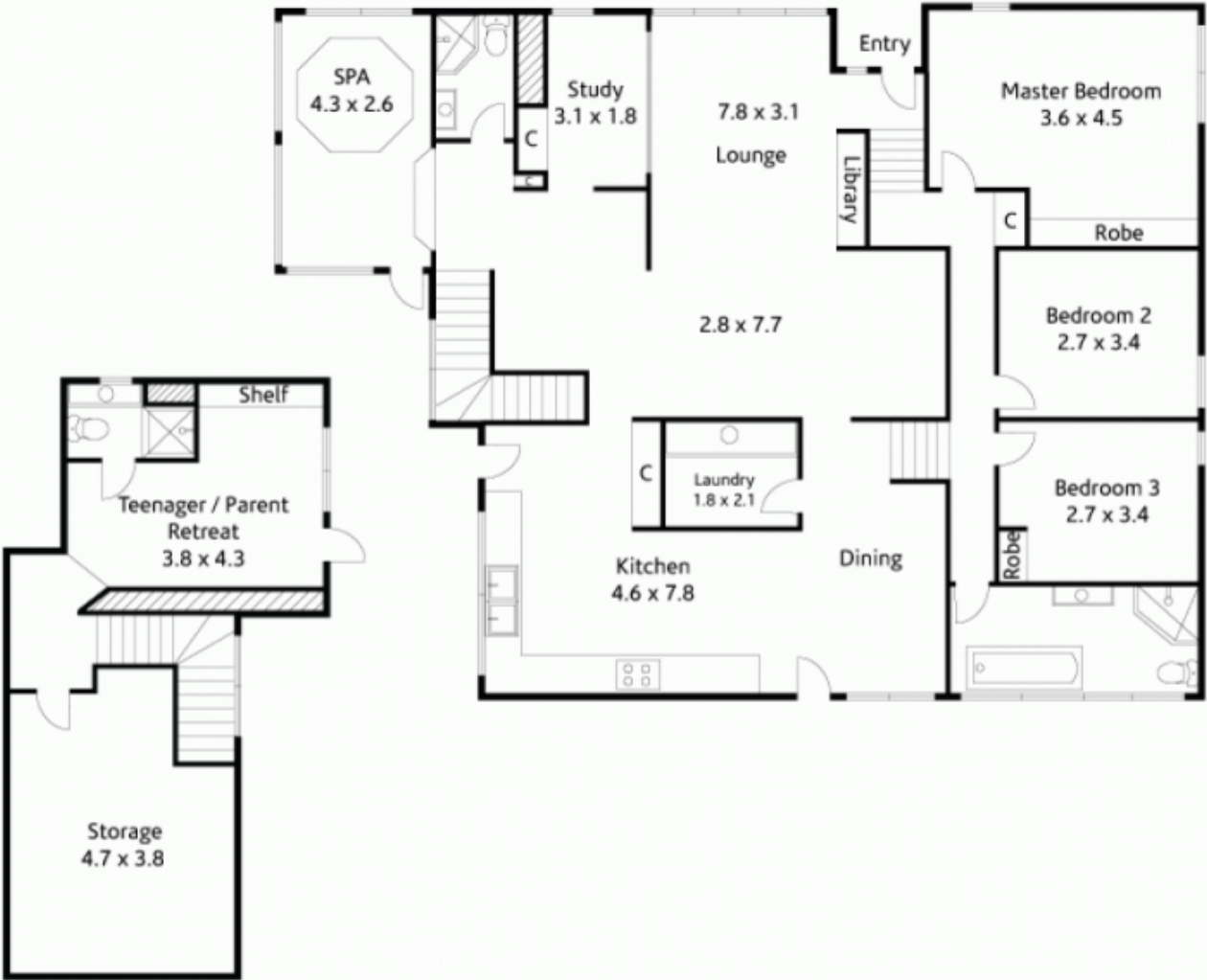

Site Plan