



23A Clarinda Street HORNSBY NSW

4  2  2 

Picturesque north facing "Woodthorpe" has the heart of a welcoming home over two functional levels, surrounded by captivating garden grounds, and set in a hushed off street position within walking distance of many local amenities.

Largely mulched gardens across approx 640sqm have been beautifully geared for aesthetic enjoyment and low maintenance, introduced by a vibrant display of roses, hibiscus and frangipanni.

The attractive, well presented interior features a choice of spacious living areas, providing a flexible, family friendly layout that begins in the carpeted living and formal dining area, flowing to casual dining and the large light-filled gas kitchen complete with breakfast bar, and Fisher and Paykel

Type : House

View : <https://www.mcdonaghrealestate.com.au/sale/nsw/north-shore-upper/hornsby/residential/house/7473590>

[For full version visit the website](https://www.mcdonaghrealestate.com.au)



First Level

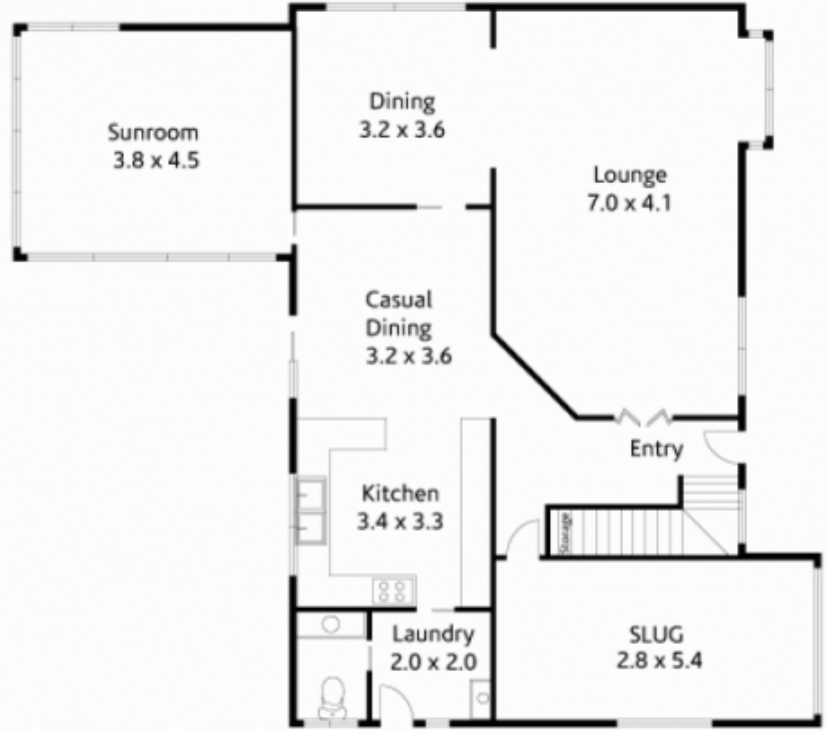

Ground Level

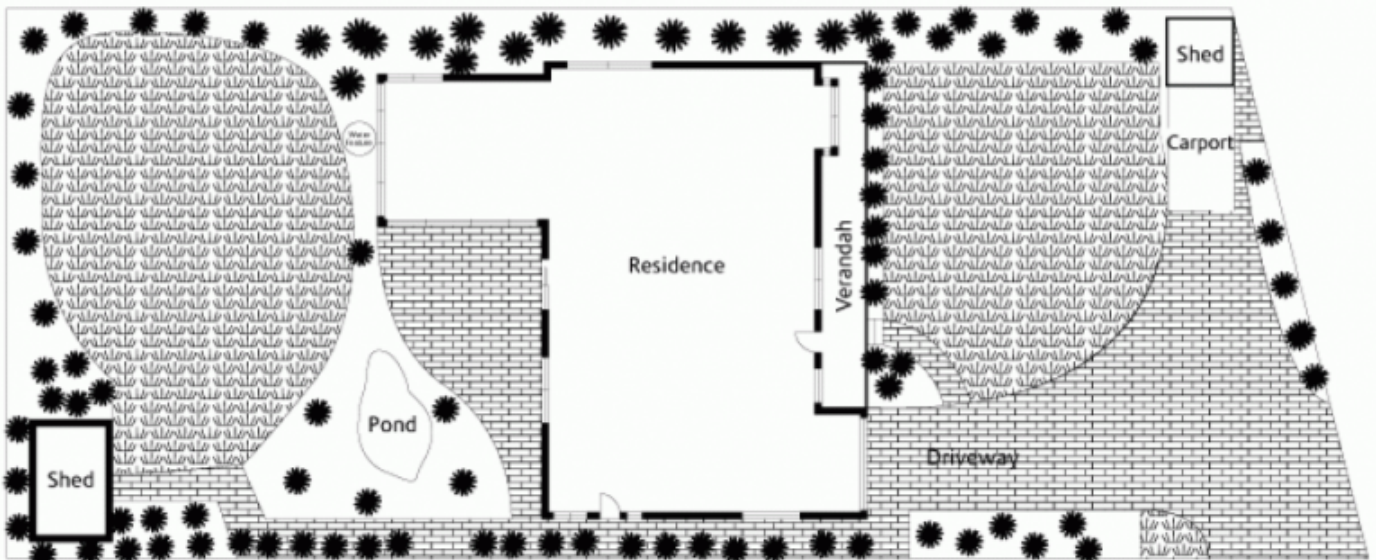

Site Plan