



2 Gloria Close MOUNT COLAH NSW

3  1  1 

A recent renovation presents this charming single level home in picture perfect as new condition - poised on an enviable corner position of approx 790sqm.

The beautifully manicured hedge garden complements the tranquil street setting and gracefully introduces the home. Comfortable, immaculately presented interiors feature wooden floors and large windows framing natural outlooks from every room.

Air-conditioned living flows to casual dining and near new, open plan kitchen - wrapped with plenty of bench space. Continue outside to a vast sheltered patio for seamless indoor outdoor interaction as the ultimate outdoor rumpus and an entertainer's delight. A natural sandstone wall

Type : House
Price : \$ 570,000
Land Size : 790 sqm
View : <https://www.mcdonaghrealestate.com.au/sale/nsw/north-shore-upper/mount-colah/residential/house/7473569>

[For full version visit the website](https://www.mcdonaghrealestate.com.au)

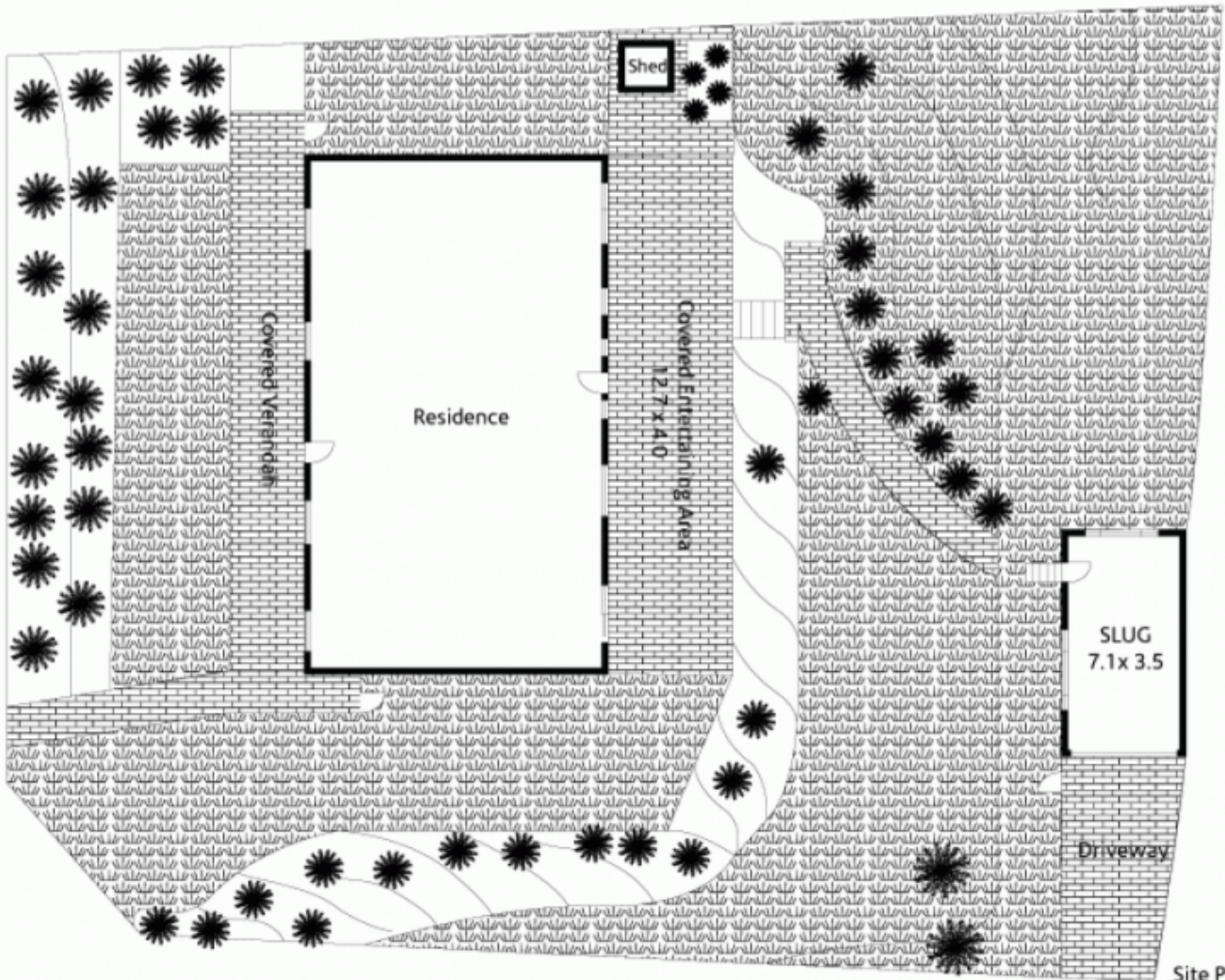

Site Plan