



6 Lockerbie Road THORNLEIGH NSW

3  **1**  **1** 

A classic picket fence, balustraded verandah and c1920's style leadlight door introduce this adorable worker's cottage with 3 queen sized bedrooms and positioned on 701.88 sqm approx of land, in an exceptionally convenient location. The rear of the house and the backyard make quite an indoor/outdoor at-home leisure centre, which is also surprisingly quiet. The kitchen (with cork floors) is open plan to the casual dining and lounge room (with parquet floors) which is a gorgeous space filled with north and east light via French doors and windows on two sides. This flows out to a wrap-around courtyard with a Turbo BBQ connected to natural gas. Adjacent to this are a large powered carport, a patio (great for a large trampoline), a cubby house and large home office opening onto lawn, all made private by Leighton Green hedges. This separate

Type : House

View : <https://www.mcdonaghrealestate.com.au/sale/nsw/northern-suburbs/thornleigh/residential/house/7473464>

[For full version visit the website](https://www.mcdonaghrealestate.com.au)

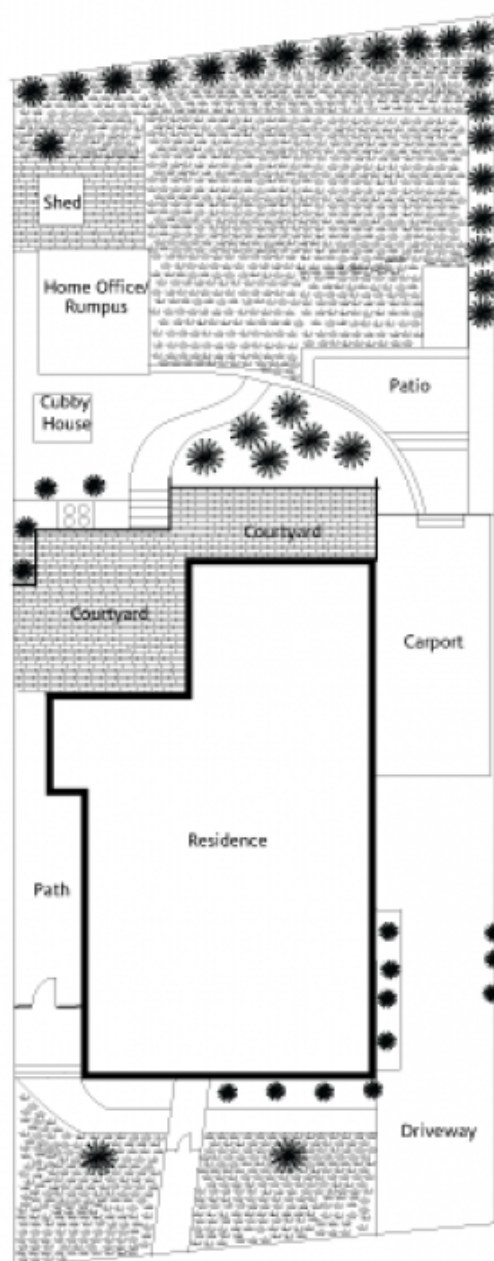
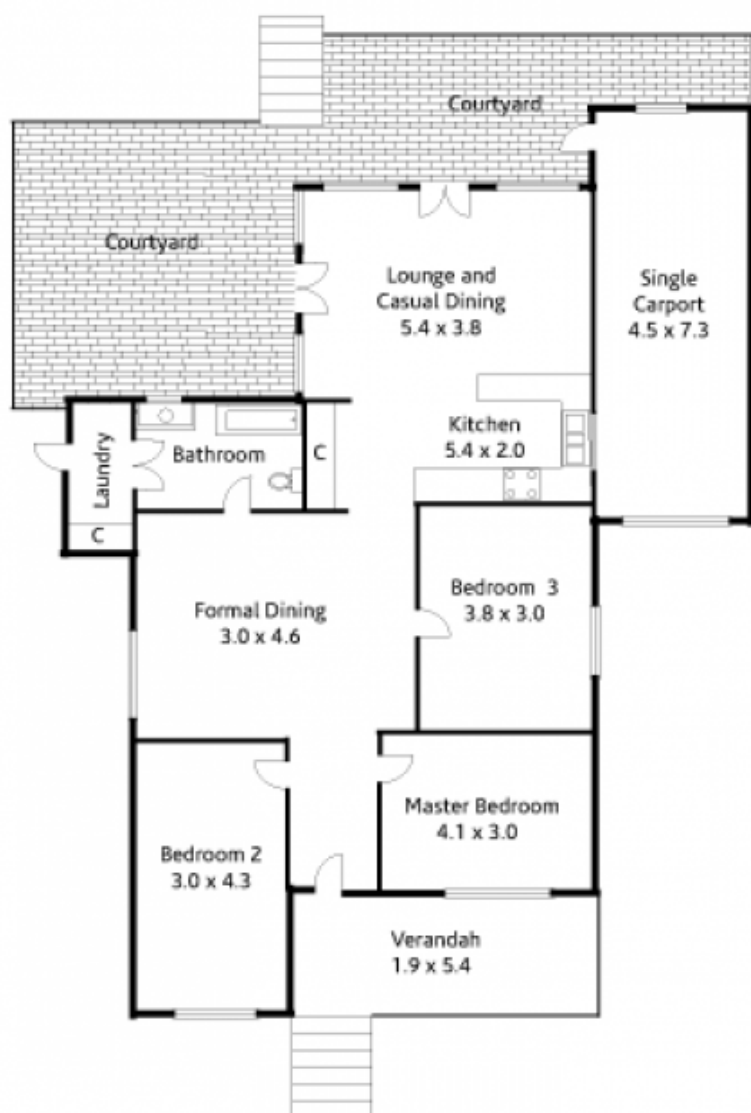

Site Plan