





15 Playfair Road MOUNT COLAH NSW

2  3  1 

Extensive northwesterly views down into Berowra Valley Regional Park are enjoyed from the kitchen, balcony, garage, rumpus and both bedrooms. The 2 oversized king bedrooms are of equal enormity, bestowing the pleasurable feelings of air and space around you, with one bedroom opening onto the balcony. Additionally, the wall between the bedrooms is non-structural, so it would be very easy to reconfigure the space by adding a hallway and creating a total of 4 bedrooms upstairs. The home is built in quality brick with polished cypress pine floorboards.

Features also include 3 bathrooms, a large internal laundry, interesting light fittings and a very large kitchen that is open plan to the dining room, which then flows out to a wide bricked patio. The house is positioned to the front of the

Type : House
Land Size : 965 sqm
View : <https://www.mcdonaghrealestate.com.au/sale/nsw/north-shore-upper/mount-colah/residential/house/7473387>



Peter McDonagh
 0410 587 856

[For full version visit the website](https://www.mcdonaghrealestate.com.au)

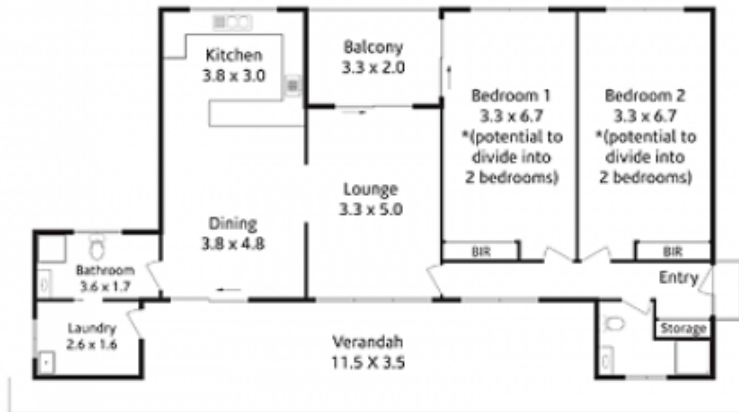

Upper Ground Floor

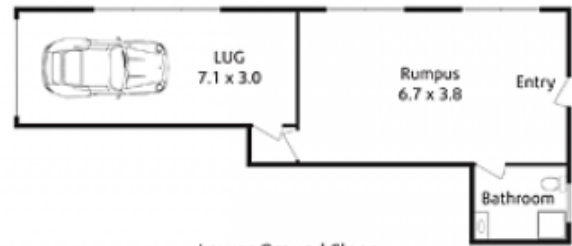

Lower Ground Floor