



56 Lonsdale Avenue BEROWRA HEIGHTS NSW

3  **2**  **1** 

An uncommon street presence echoes the historical and the European in this 3 bedroom, 2 bathroom, 1 study home that is soaked with character and sits on 920sqm approx of land. Built in full sandstone (hand hewn by an Italian stonemason) and brick, it has French windows, internal sandstone features and timber wall panelling and overlooks a gorgeous parterre style front garden with carefully clipped topiary shrubs, low box hedges, winding pebble pathway and a white picket fence. It has on site parking for one car and further potential undercover parking (STCA) at the rear. The safe and completely enclosed back yard is great for children to play and for entertaining your friends. The thick walls allow for fantastic climate control and eco-efficiency and the scale of the garden is very maintenance- friendly in relation to the large size of the

Type : House
Land Size : 920 sqm
View : <https://www.mcdonaghrealestate.com.au/sale/nsw/hawkesbury/berowra-heights/residential/house/7473377>

[For full version visit the website](https://www.mcdonaghrealestate.com.au)

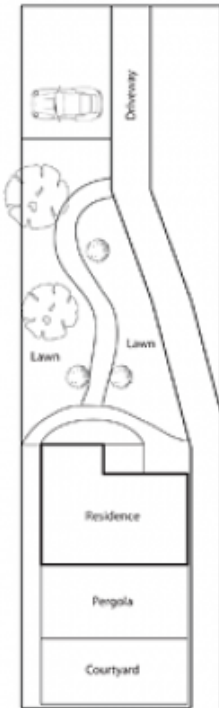

Site Plan



Ground Level

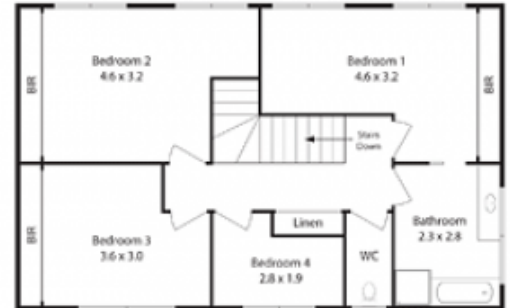

Upper Level

Council Rates: 5272.00 p.q. approx.
Water Rates: 5120.00 p.q. approx.
Land Size: 770 sqm approx.