



173A Somerville Road HORNSBY HEIGHTS NSW

3  2  2 

Beautiful and immaculate, this 3 bedroom, 2 bathroom, double carport home has a gorgeous view and landscaped gardens. Peace and tranquillity surround and permeate this northfacing home, which is well built in brick with cypress floorboards, and has given one family much joy over the last 36 years. The versatile 1119sqm approx block offers plenty of room to move with it's over 50ft approx frontage and a 30ft wide level shared driveway, which is perfect for the kids to play cricket or learn to ride a bike. The back yard is a haven for gardeners, kids and nature lovers with its terraced lawn sections that flow into the adventure paradise that is the Berowra Valley Regional Park. The captivating view can be enjoyed from the lounge and dining room, that flows onto an enormous wrap around deck, and from the verandah underneath.

Type : House
Land Size : 1119 sqm
View : <https://www.mcdonaghrealestate.com.au/sale/nsw/north-shore-upper/hornsby-heights/residential/house/7473376>

[For full version visit the website](https://www.mcdonaghrealestate.com.au)

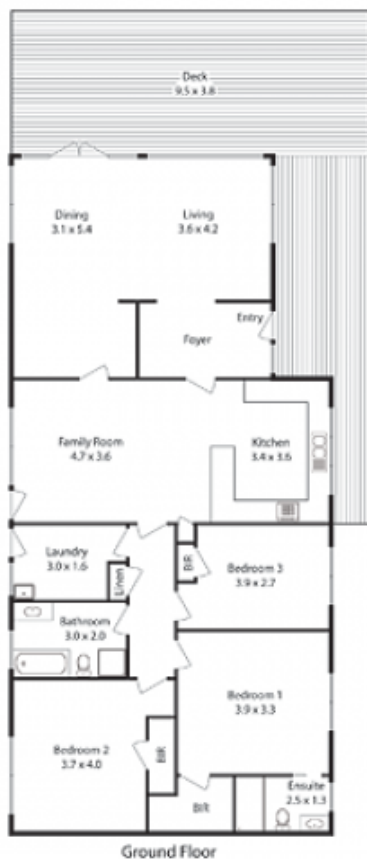

Ground Floor

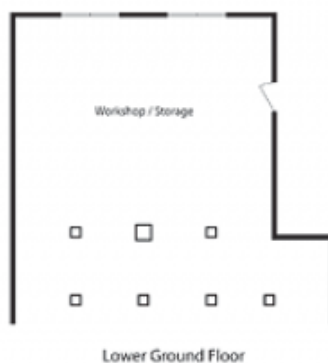

Lower Ground Floor



Site Plan

Council Rates: \$280.42 p/q. approx.
Water Rates: \$230.75 p/q. approx.
Land Size: 1119 sqm. approx.

173A Somerville Road, Hornsby Heights

McDonagh Blake has taken every effort to ensure the information in this brochure is accurate to the best of our knowledge, however it is a promotional document only for use as a guide, and no detail should be relied upon. McDonagh Blake accepts no liability for how the information is used.