



**1 Willarong Road MOUNT COLAH NSW**

2 1 1

Stacked with potential and offering privacy this solidly built 2 bedroom 1.5 bathroom house has cypress pine floors under the present floor coverings. Completely liveable, once freshened up with new paint and by revealing the floorboards, the master bedroom faces north and the lounge room has windows to the view and the north. Leafy greenness beckons from the very spacious eat-in kitchen, and from the sunroom, which is large enough to partition into a 3rd bedroom.

Just the 771.4 sqm approx of land alone presents fantastic value, as the potential is there (STCA) to build two stories to maximise the existing view of picturesque Asquith golf course. Hidden from the Pacific Highway on the east side end of Willarong Road, the location is midway between

**Type** : House  
**Land Size** : 771 sqm  
**View** : <https://www.mcdonaghrealestate.com.au/sale/nsw/north-shore-upper/mount-colah/residential/house/7473345>



**Peter McDonagh**  
**0410 587 856**

[For full version visit the website](https://www.mcdonaghrealestate.com.au)

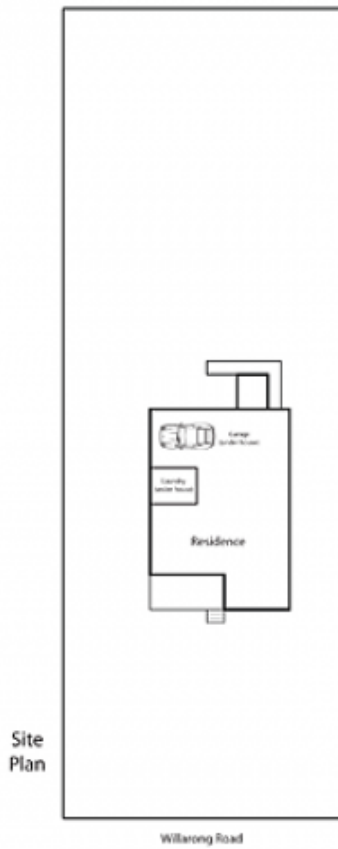

Water Rates: \$153.45 p.u.g. approx.  
Council Rates: \$290.16 p.u.g. approx.  
Land Size: 771.4 sqm approx.