



1 Joalah Crescent BEROWRA HEIGHTS NSW

4  3  2 

Surrounded by professionally created Australian native gardens this solidly built 2-storey brick home sits on a generous 701sqm approx corner block. In a relaxed, leafy, very private, very quiet environment the property is suited for a range of family requirements having 4 bedrooms, 3 bathrooms and 4 separate living spaces. Three of the bedrooms have built-ins and two have ensuites. The ground floor has a spacious self-contained 1-bedroom apartment, which could be used for sub-letting, in-law or teenage accommodation or for a games room and home office. The home has an excellent internal laundry, with just steps to the clothesline, and internal access to an auto door double lock-up garage. Upstairs the substantial as-new first floor kitchen looks out to a marvellous rear deck, is open to a breakfast and living area with combustion fireplace, and

Type : House
Land Size : 701 sqm
View : <https://www.mcdonaghrealestate.com.au/sale/nsw/hawkesbury/berowra-heights/residential/house/7473336>

[For full version visit the website](https://www.mcdonaghrealestate.com.au)



Site Plan

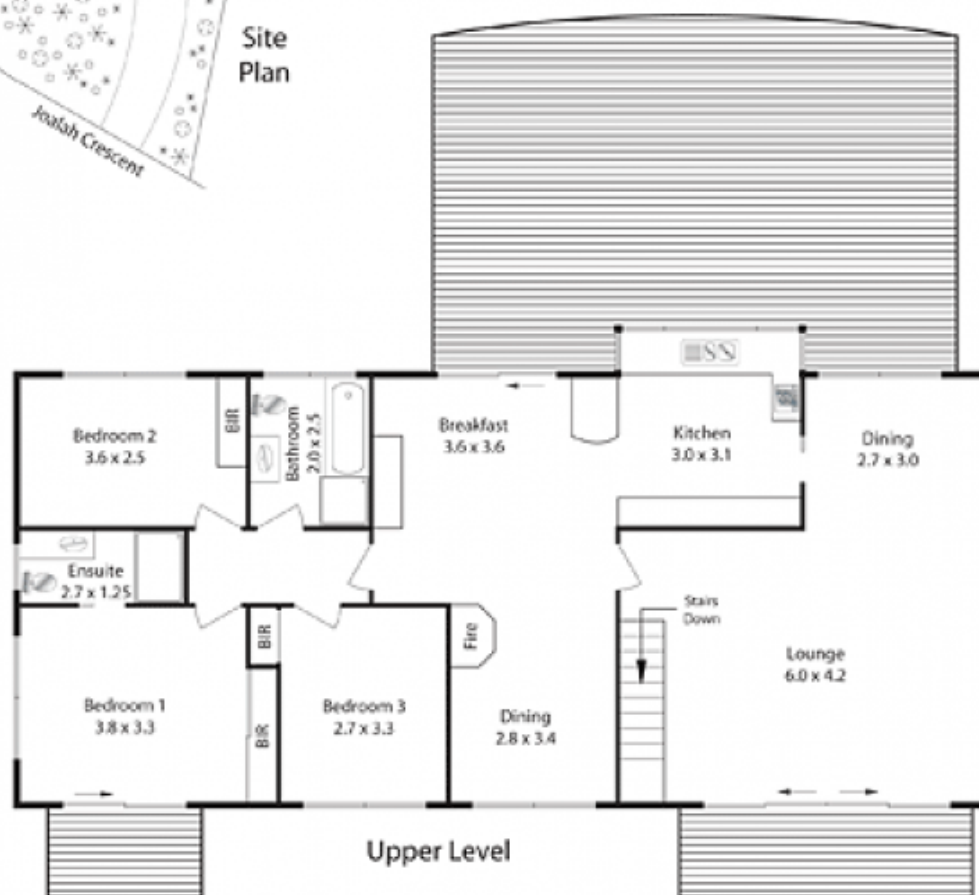

Upper Level



Ground Level

Water Rates: \$206.60 p.q. approx.
Council Rates: \$286.40 p.q. approx.
Land Size: 701 sqm. approx.