



108 Dartford Road THORNLEIGH NSW

3 1 1

Sitting confidently on 1783sqm approx of northeast facing land, with good elevation for privacy and captivating views across Waitara Creek valley to Hornsby, this property presents a great opportunity (STCA) to subdivide, develop the site for re-sale, or create a dream home and lifestyle. Take advantage of living comfortably in the existing house, with plenty of yard for the kids to play, and then re-build or sub-divide later. Whatever direction you favour to maximise the potential of for your new found treasure, you will be positioning yourself for a strong future.

Type : House

View : <https://www.mcdonaghrealestate.com.au/sale/nsw/northern-suburbs/thornleigh/residential/house/7473317>

Well located, it is quieter than Hornsby, yet only one train

[For full version visit the website](#)



Site Plan

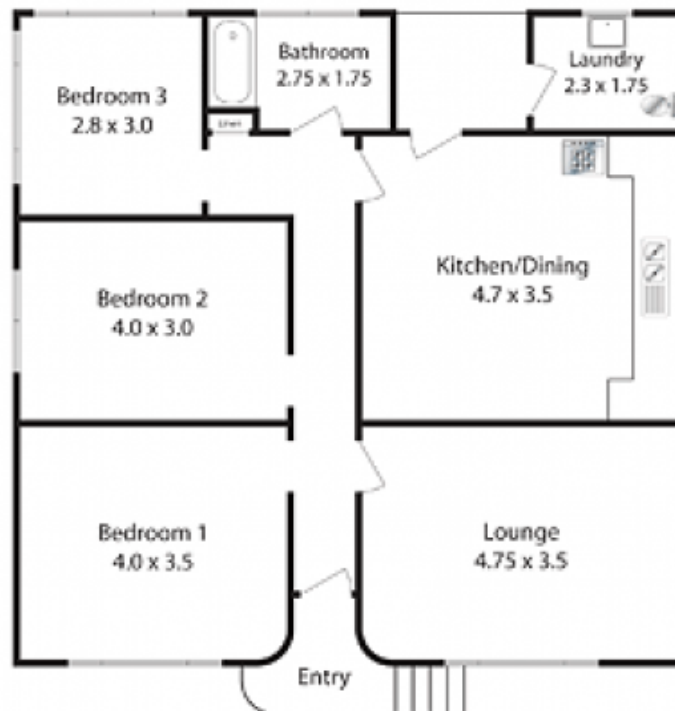

Council Rates: \$TBA p/q approx.
Water Rates: \$119.00p/q approx.
Land Size: 1785.1 sqm approx.