



**29 Wanda Crescent BEROWRA HEIGHTS NSW**

4  3  2 

An awe-inspiring haven of elegance and spaciousness in a private and serene bushland setting. Spanning three levels of enviable accommodation, this 4 bedroom, 2.5 bathroom, DLUG contemporary home on 1068.6 sqm approx of land is designed for a 'family-with-purpose'. The mid-level deck is a favourite retreat, which flows down to a Tuscan style BBQ courtyard and thence to the pool. Internal access from the DLUG directly to a magnificent kitchen with superior grade finishes including S/S appliances, vast granite bench tops and sparkling white cabinetry, asserting the intelligent design of the home. The laundry and the master bedroom's walk-in-robe are of such a scale that they could be classified as rooms in their own right. Contemporary colours and features continue with floating floorboards in high traffic areas, keyhole walls and wall niches for mirrors

**Type** : House

**View** : <https://www.mcdonaghrealestate.com.au/sale/nsw/hawkesbury/berowra-heights/residential/house/7473310>

[For full version visit the website](https://www.mcdonaghrealestate.com.au)

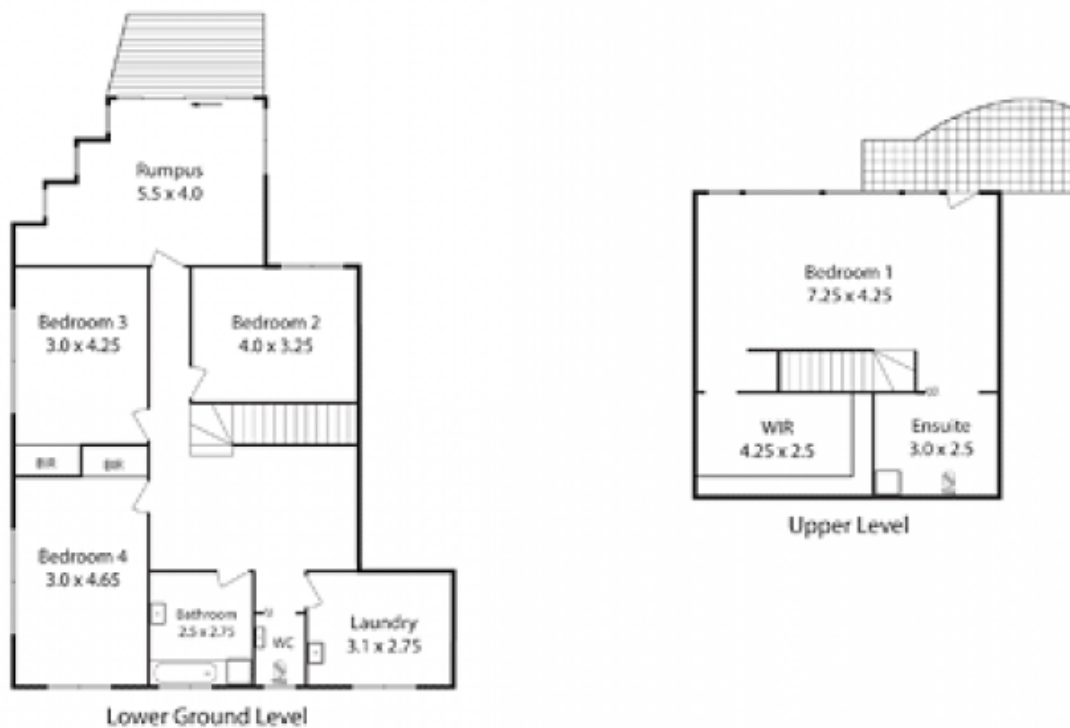
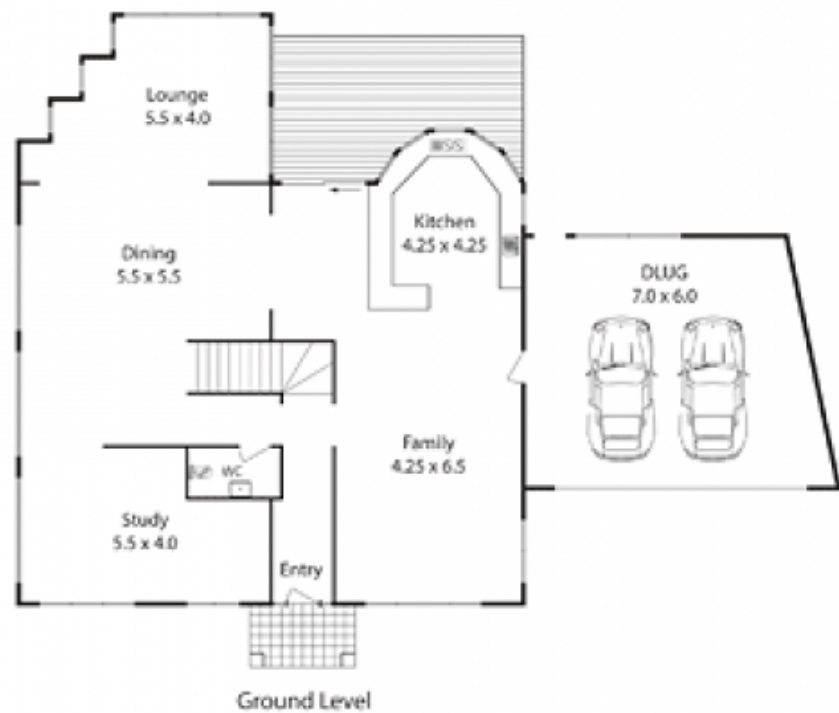

Council Rates: \$256.81 p.q. approx.  
Water Rates: \$167.95 p.q. approx.  
Land Size: 1068.6 sqm approx.